

Illustrated Index



Lubricate all internal parts with engine oil during reassembly.

NOTE:

- Apply liquid gasket to the mating surfaces of the rear cover and oil pump before installing them.
- Use liquid gasket, part No. 08718 - 0001.

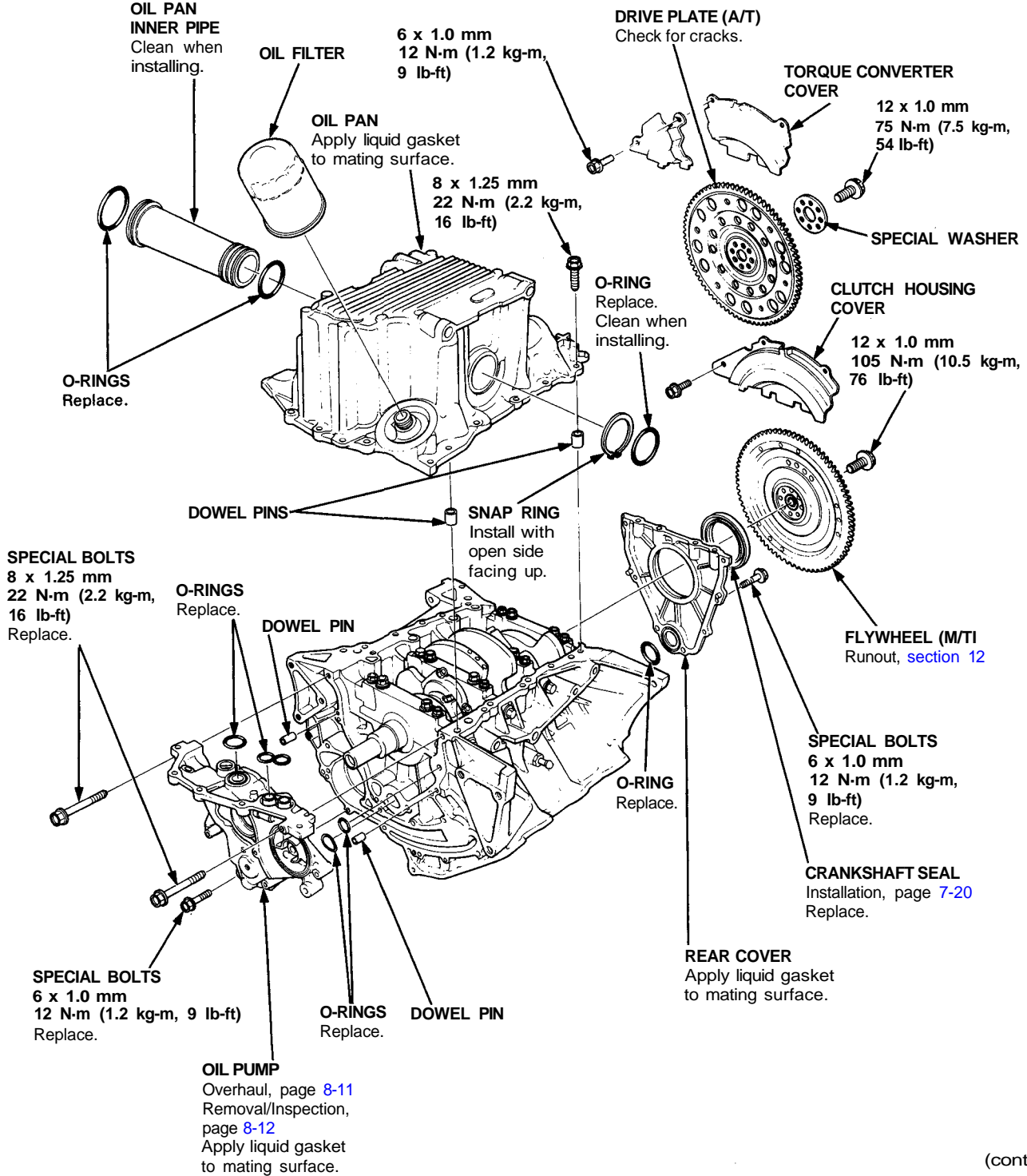

(cont'd)

Illustrated Index

(cont'd)

NOTE:

- Lubricate all internal parts with engine oil during reassembly.
- Use liquid gasket. Part No. 08718 — 0001.

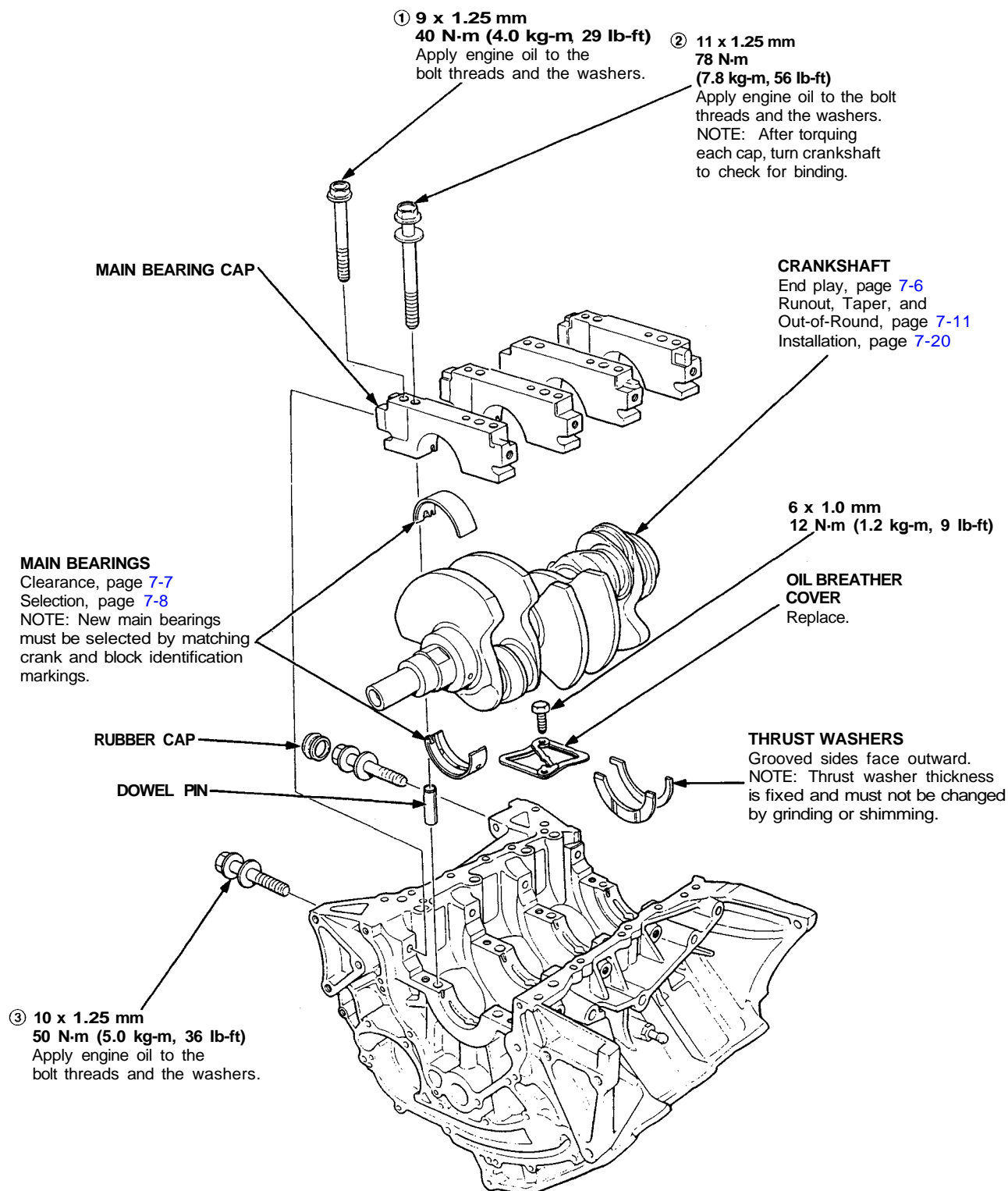



NOTE: New rod bearings must be selected by matching connecting rod assembly and crankshaft identification markings (see page 7-8).



Lubricate all internal parts with engine oil during reassembly.

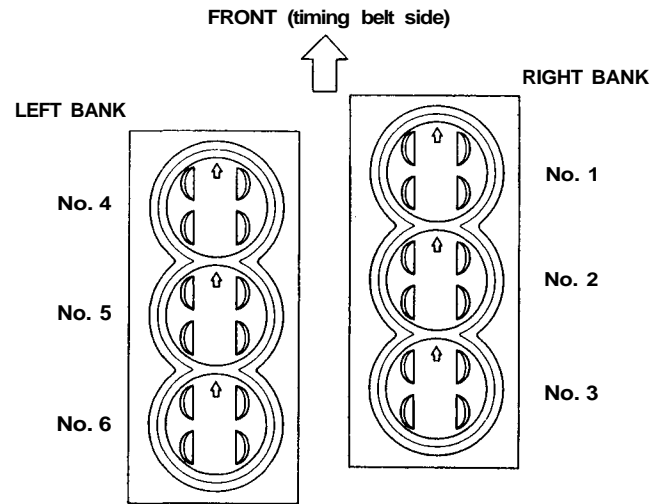

PISTON

Inspection, page 7-12

NOTE:

- Before removing piston, inspect the top of the cylinder bore for carbon build-up or ridge. Remove ridge if necessary, page 7-9.
- To maintain proper piston clearance, match the letter on the piston top (No letter denotes A) with the letter for each cylinder stamped on the block.

PISTON PIN

Removal, page 7-14

Installation, page 7-15

Inspection, page 7-16

CYLINDER BLOCK

Cylinder bore inspection, page 7-13

Warpage inspection, page 7-13

Cylinder bore honing, page 7-14

CONNECTING ROD BEARING CAP

Installation, page 7-20

NOTE: Install caps so the bearing recess is on the same side as the recess in the rod.

PISTON RINGS

Replacement, page 7-17

Measurement, pages 7-17 and 18

Alignment, page 7-18

CONNECTING ROD

End play, page 7-6

Selection, page 7-15

Inspect top of each cylinder bore for carbon build-up or ridge before removing piston.

Remove ridge if necessary, page 7-9

CONNECTING ROD BEARING

Clearance, page 7-7

Selection, page 7-8

CONNECTING ROD CAP NUT

9 x 0.75 mm

45 N·m (4.5 kg-m,

33 lb-ft)

After torquing each bearing cap, rotate crankshaft to check for binding.



CYLINDER BORE SIZES

NOTE: To maintain proper piston clearance, match these letters with the letters on the pistons. The letters on the block read from front to rear, No. 1 through No. 3 cylinders on the first line and No. 4 through No. 6 cylinders on the second line.